

BOUNDARY PLAN OF R.S. AND L.R. DAG NO.- 257 & 258 (PART), R.S. KHATIAN NO.- 302 & 599, L.R. KHATIAN NO.- 4346, 4347, 4348, 4349, 4350 & 4930, AT MOUZA - SAONARPUR (SH. NO.- 01), J.L. NO.- 39, RE.SA. NO.- 13, TAUZI NO.- 109, P.S. & BLOCK - SONARPUR, DIST.- SOUTH 24 PARGANAS, UNDER RAJPUR- SONARPUR MUNICIPALITY, WARD NO.- 13.

LAND AREA = 1070.234 SQ M = 16 KH - 00 CH - 00 SQ FT (AS PER DEED)

LAND AREA = 1064.935 SQ M = 15 KH - 14 CH - 32.96 SQ FT (AS PER PHYSICAL MEASUREMENTS) □



SCALE = 1:300

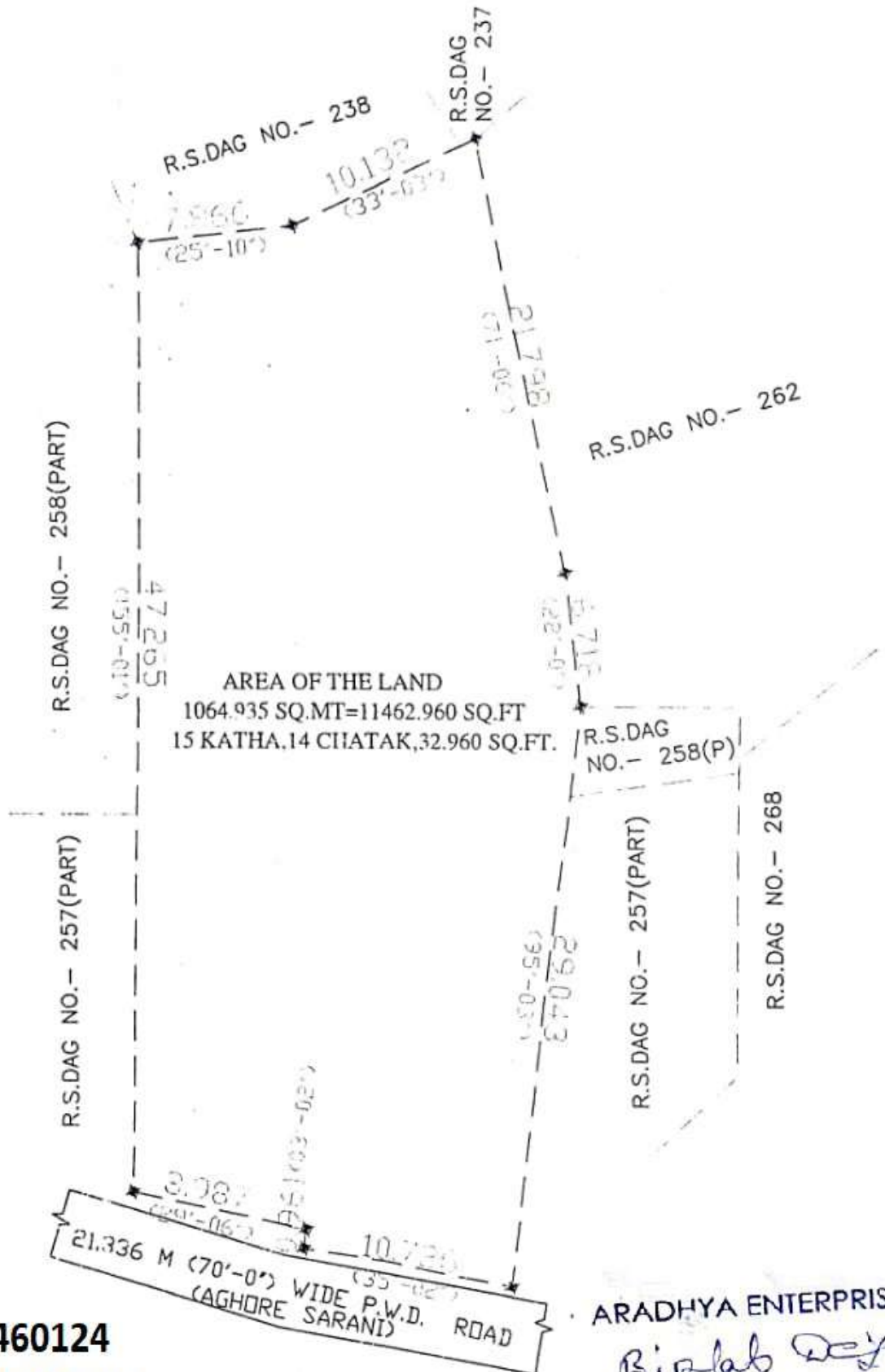

LATITUDE : 22.460124

LONGITUDE : 88.399087

ARADHYA ENTERPRISE

Bipalab Dey
Partner

SIGNATURE OF OWNER